

Service Bulletin

SB 60-6

8-5-82



SUBJECT: REAR HUB SEAL RINGS
VEHICLES:

Starting with the following chassis numbers:

CAR TYPE	EUROPEAN VERSION	U.S.A. VERSION
208 GTB/GTS	41265	----
308 GTBi/GTSi	41295	41289
MONDIAL 8	41133	41111
400 Injection	41169	----
512 BBi	41605	

GENERAL INFORMATION:

All cars are fitted with new rear hub seal rings installed on the half-shaft side of the rear suspension uprights. The new assembly, shown in Fig. 1, can be installed also on previous cars, and is made up with 3 new parts, identified in Fig. 1 with their part numbers, which replace the corresponding old items.

Necessary precautions for fitting up:

- The new seal ring (p.n. 115968) must be left soaking in engine oil for at least 24 hours before installation.
- The flange for bearing (p.n. 119417) has the recess (A) which must be positioned in the highest point in order to avoid a possible pocket between flange and upright where water and dirt could be trapped.
- The surface (B) of the upright, must be coated with a thin but uniform film of silicone sealing paste, like for instance CAF 1 or CAF 4, before the flange is installed.

NOTE:

When the rear suspension uprights will be available, in the future, with the modified shape shown by the dotted line (C) in Fig. 1, the new cars will be fitted with the flange for bearing p.n. 119374, shown in Fig. 2.

This last flange differs from the one shown in Fig. 1, only because it is a complete circle, without the recess A, and it will only be used for new cars with modified uprights.

The present Technical Bulletin must be considered an updating of all Spare Parts Catalogues of the listed car types.

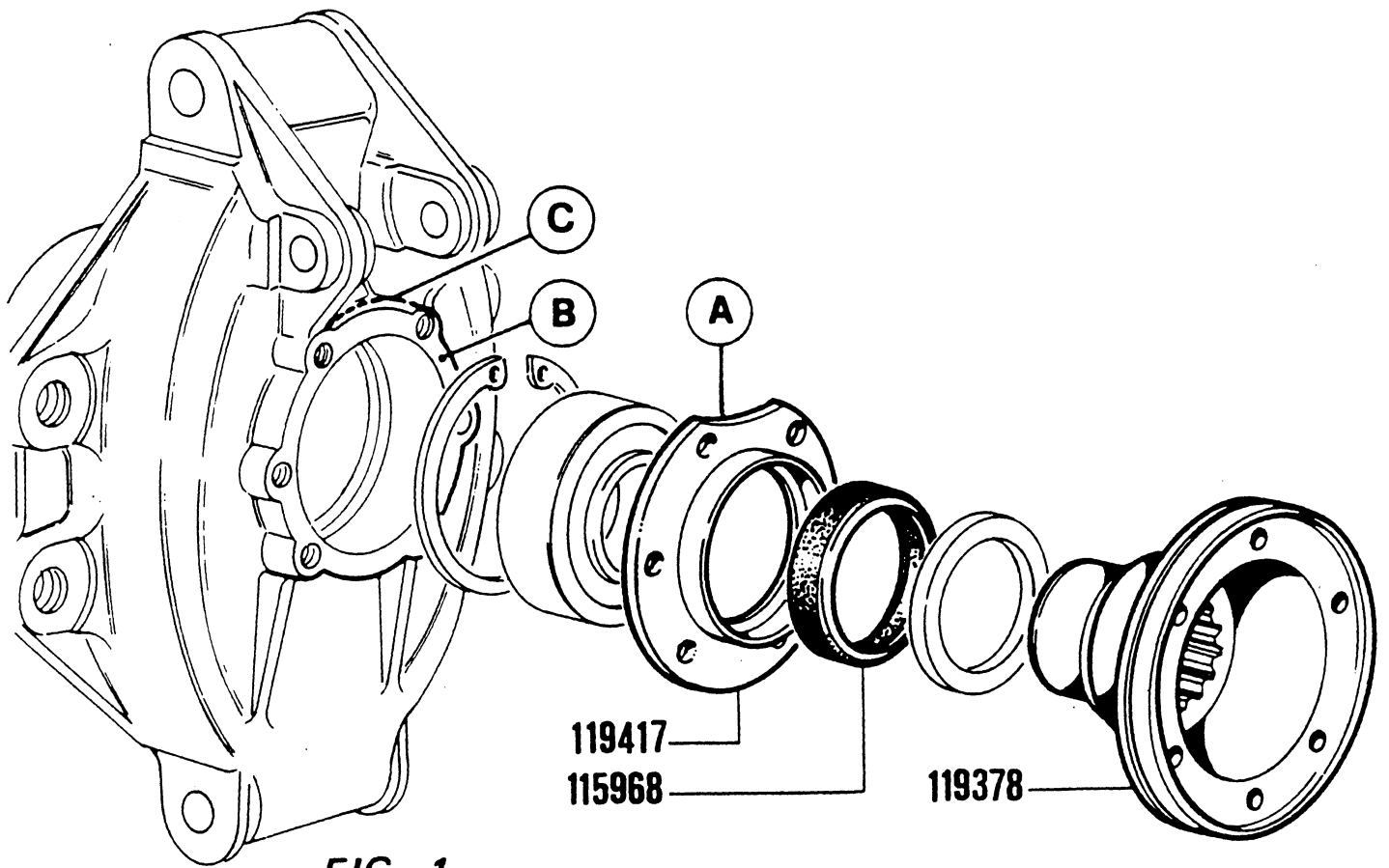

FIG. 1

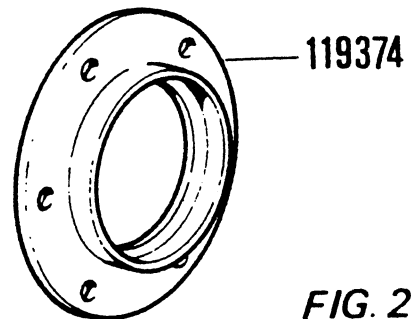

FIG. 2